

vtech®

User's Manual

Go! Go! Smart Wheels™
Playtime with miles of learning!

Car Carrier



© 2013 VTech
Printed in China
91-002764-014 (USA)

Dear Parent,

Welcome to the world of **Go! Go! Smart Wheels™**! We're excited you've decided to ride along with us and explore all that **Go! Go! Smart Wheels™** has to offer. These toys have been designed to give your child a thrilling learning experience with hours and hours of fun as well.

Go! Go! Smart Wheels™ features vehicles that interact with your child by lighting up, singing and talking, while teaching your child letters and vehicle names (each sold separately). There are other surprises in store, too! With our innovative **SmartPoint™** technology, available exclusively on **Go! Go! Smart Wheels™** playsets (each sold separately), your child will smile as they hear **SmartPoint™** vehicles respond to each unique **SmartPoint™** location with singing, sound effects and fun phrases.

Our **Go! Go! Smart Wheels™** playsets also feature buttons, gears and other mechanical features to encourage the development of your child's fine motor skills. Many of the playsets also have tracks that can be arranged in endless ways, stimulating your child's creativity. In addition, many of the **Go! Go! Smart Wheels™** playsets connect to other playsets in the collection, so there's no end to what your child can do!

With **Go! Go! Smart Wheels™**, it's playtime with miles of learning!

Sincerely,
Your friends at **VTech®**

To learn more about **VTech®** toys, visit www.vtechkids.com

INTRODUCTION

Thank you for purchasing the **VTech® Go! Go! Smart Wheels™ Car Carrier** learning toy!

The **Go! Go! Smart Wheels™ Car Carrier** is a big truck with big style! This car carrier comes with one vehicle and can hold up to six **Go! Go! Smart Wheels™** vehicles (sold separately). With its drop-down ramp, back gate, and six accessory play pieces, your child will love loading up the car carrier as they pretend and play. For added interaction, this truck recognizes all **Go! Go! Smart Wheels™** vehicles (sold separately) and includes one **SmartPoint™** location. The car carrier also has three shape buttons and a number pad that teaches numbers and colors.

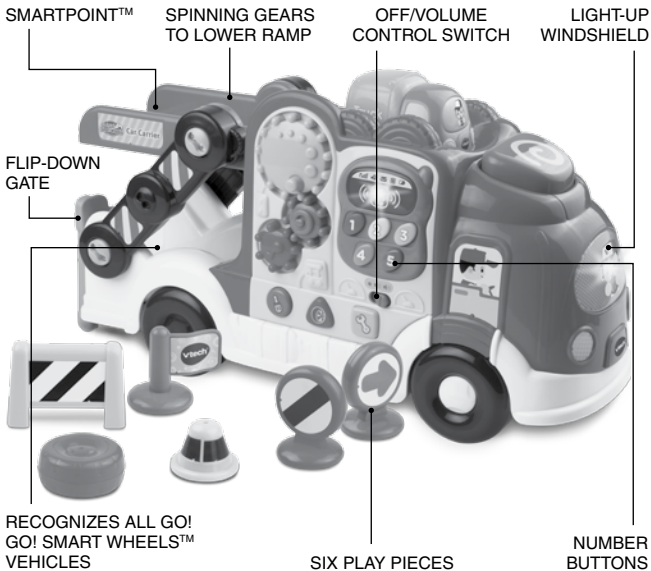

INCLUDED IN THIS PACKAGE

- One VTech® Go! Go! Smart Wheels™ Car Carrier
- One user's manual
- One truck
- Six play pieces

WARNING:

All packing materials, such as tape, plastic sheets, packaging locks and tags are not part of this toy, and should be discarded for your child's safety.

ATTENTION:

Pour la sécurité de votre enfant, débarrassez-vous de tous les produits d'emballage tels que rubans adhésifs, feuilles de plastique, attaches et étiquettes. Ils ne font pas partie du jouet.

NOTE:

Please keep user's manual as it contains important information.

Please cut and discard the plastic tie between the ramp and the top platform before playing with the unit. This plastic tie is not part of the product and should be discarded for your child's safety.

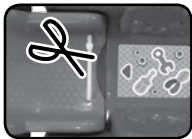

GETTING STARTED

BATTERY INSTALLATION

1. Make sure the unit is turned **OFF**.
2. Locate the battery cover on the bottom of the car carrier. Use a coin or a screwdriver to loosen the screw.
3. Install 2 new 'AA' (AM-3/LR6) batteries following the diagram inside the battery

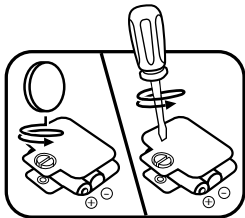

box. (The use of new alkaline batteries is recommended for maximum performance.)



4. Replace the battery cover and tighten the screw to secure the battery cover.

BATTERY NOTICE

- Use new alkaline batteries for maximum performance.
- Use only batteries of the same or equivalent type as recommended.
- Do not mix different types of batteries: alkaline, standard (carbon-zinc) or rechargeable (Ni-Cd, Ni-MH), or new and used batteries.
- Do not use damaged batteries.
- Insert batteries with the correct polarity.
- Do not short-circuit the battery terminals.
- Remove exhausted batteries from the toy.
- Remove batteries during long periods of non-use.
- Do not dispose of batteries in fire.
- Do not charge non-rechargeable batteries.
- Remove rechargeable batteries from the toy before charging (if removable).
- Rechargeable batteries are only to be charged under adult supervision.

PRODUCT FEATURES

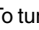
1. OFF/VOLUME CONTROL SWITCH

To turn the unit **ON**, slide the **Off/Volume Control Switch** to the **Low Volume** () or the **High Volume** () position. To turn the unit **OFF**, slide the **Off/Volume Control Switch** to the **OFF** () position.



2. AUTOMATIC SHUT-OFF

To preserve battery life, the **VTech® Go! Go! Smart Wheels™ Car Carrier** will automatically power-down after approximately 30 seconds without input. The unit can be turned on again by pressing any button.



ACTIVITIES

1. Slide the **Off/Volume Control Switch** to turn on the unit. You will hear a sing-along song, a phrase and a sound effect. The lights will flash with the sounds.
2. Press the **Button** on the roof of the car carrier to hear sounds, a phrase, a short tune, fun music and a sing-along song. The lights will flash with the sounds.
3. Press the **Number Buttons** and you will hear phone sounds, numbers, colors, phrases, fun sounds and short tunes. The light on the phone screen will flash with the sounds.
4. Press the three **Shape/Tool Buttons** to learn shapes and phrases about using the tools to fix the car carrier. The light on the phone screen will flash with the sounds.

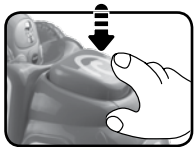

5. For added fun, the car carrier features a **SmartPoint™** location on the **Ramp**. Roll a **SmartPoint™** vehicle over the **SmartPoint™** to see the vehicle's light flash and to hear greetings, fun sounds, short tunes and sing-along songs. Drop down/lock up the **Ramp** to hear sounds and phrases. The light will flash with the sounds.



6. Turn the **Gears** to hear fun sounds and see the ramp drop down. The lights will flash with the sounds.



7. While a vehicle is on the recognition sensor, press down or quickly push the vehicle through the sensor to hear a greeting. The lights will flash with the sounds.



8. If a melody is playing, push the car carrier to hear fun sounds. If no other response is playing, push the car carrier to hear fun sounds and music.

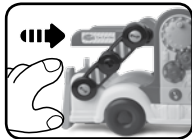

9. After a vehicle has been recognized and the car carrier sits idle for approximately 8 seconds, you will hear a reminder to find that vehicle. If no vehicle has passed through the recognition sensor and the unit sits idle for approximately 8 seconds, you will hear sound effects and a sing-along song. If there is still no input for another 8 seconds, you will hear closing short tune, and the unit will go into sleep mode. The unit can be re-activated by pressing any button except the recognition sensor.

MELODY LIST

1. I've Been Working on the Railroad
2. London Bridge
3. Three Blind Mice
4. It's Raining, It's Pouring
5. Humpty Dumpty
6. Old King Cole

SUNG SONG LYRICS

Carry vehicles around the town.
Load them up, then roll them down.
Driving, learning along the way.
Learning's so much fun today!

CARE & MAINTENANCE

1. Keep the unit clean by wiping it with a slightly damp cloth.
2. Keep the unit out of direct sunlight and away from any direct heat source.
3. Remove the batteries when the unit is not in use for an extended period of time.
4. Do not drop the unit on hard surfaces and do not expose the unit to moisture or water.

TROUBLESHOOTING

If for some reason the program/activity stops working or malfunctions, please follow these steps:

1. Please turn the unit **OFF**.
2. Interrupt the power supply by removing the batteries.
3. Let the unit stand for a few minutes, then replace the batteries.
4. Turn the unit **ON**. The unit should now be ready to play again.

5. If the product still does not work, replace with an entire new set of batteries.

If the problem persists, please call our Consumer Services Department at 1-800-521-2010 in the U.S. or 1-877-352-8697 in Canada, and a service representative will be happy to help you.

For information on this product's warranty, please call **VTech®** at 1-800-521-2010 in the U.S. or 1-877-352-8697 in Canada.

IMPORTANT NOTE:

Creating and developing **Infant Learning** products is accompanied by a responsibility that we at **VTech®** take very seriously. We make every effort to ensure the accuracy of the information, which forms the value of our products. However, errors sometimes can occur. It is important for you to know that we stand behind our products and encourage you to call our Consumer Services Department at 1-800-521-2010 in the U.S. or 1-877-352-8697 in Canada, with any problems and/or suggestions that you might have. A service representative will be happy to help you.

Note:

This equipment has been tested and found to comply with the limits for a Class B digital device, pursuant to Part 15 of the FCC Rules. These limits are designed to provide reasonable protection against harmful interference in a residential installation. This equipment generates, uses and can radiate radio frequency energy and, if not installed and used in accordance with the instructions, may cause harmful interference to radio communications. However, there is no guarantee that interference will not occur in a particular installation. If this equipment does cause harmful interference to radio or television reception, which can be determined by turning the equipment off and on, the user is encouraged to try to correct the interference by one or more of the following measures:

- Reorient or relocate the receiving antenna
- Increase the separation between the equipment and receiver

- Connect the equipment into an outlet on a circuit different from that to which the receiver is connected
- Consult the dealer or an experienced radio/TV technician for help

Caution: changes or modifications not expressly approved by the party responsible for compliance could void the user's authority to operate the equipment.

THIS DEVICE COMPLIES WITH PART 15 OF THE FCC RULES. OPERATION IS SUBJECT TO THE FOLLOWING TWO CONDITIONS:
(1) THIS DEVICE MAY NOT CAUSE HARMFUL INTERFERENCE, AND
(2) THIS DEVICE MUST ACCEPT ANY INTERFERENCE RECEIVED, INCLUDING INTERFERENCE THAT MAY CAUSE UNDESIRE OPERATION.

THIS CLASS B DIGITAL APPARATUS COMPLIES WITH CANADIAN ICES-003.

CET APPAREIL NUMÉRIQUE DE LA CLASSE B EST CONFORME À LA NORME NMB-003 DU CANADA.

CLASS 1
LED PRODUCT